

## Превключвател mini 3pin. on-off-on, SS12D00G3

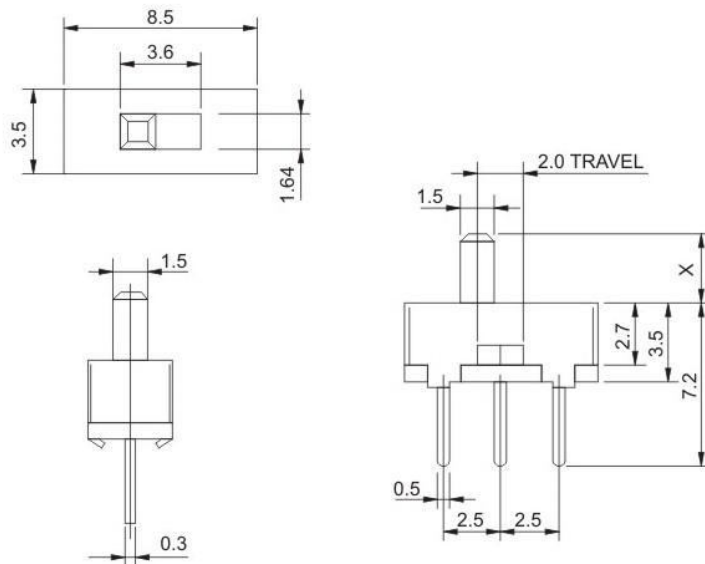
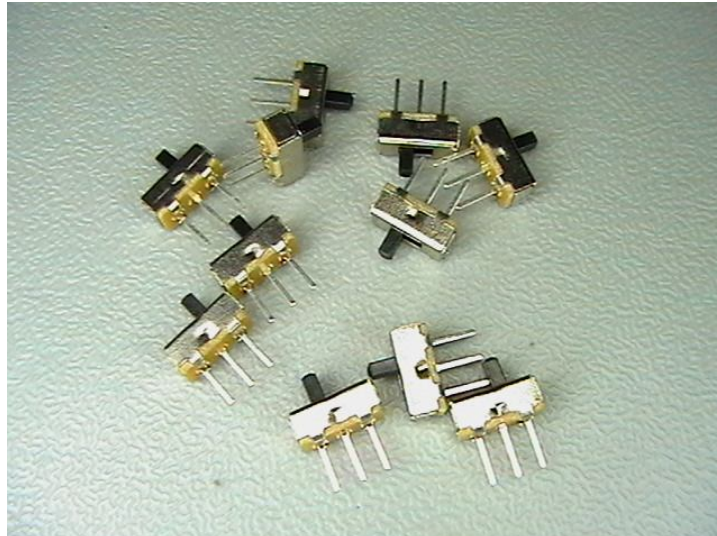

### Specifications:

Product Name Slide Switch

Model SS-12D00G3

Type 1 Pole 2 Throw

Working Power 0.5A 50V DC

Contact Resistance 30mΩ Max

Insulation Resistance 100mΩ Min at 500V DC

Withstand Voltage AC 500V for 1 min

Terminal Length 3mm/ 0.12"

Pin Pitch 2.54mm / 1"

Main Body Size(not including Pins & slide switch) 8 x 4 x 3.8mm/ 0.31" x 0.16" x 0.15"(L\*W\*H)

Switch Total Size 8 x 4 x 10mm/ 0.31" x 0.16" x 0.39"(L\*W\*H)

Slide Switch Size 1.5 x 1.5 x 3mm/ 0.06" x 0.06" x 0.12"(L\*W\*H)

Material(External) Plastic, Metal

Main Colour Silver Tone, Black

Weight 14g